

DURAFlex[®]
CALCIUM SILICATE BOARDS

EXPOSED CEILING - CONCEALED CEILING
DRYWALL & EXTERNAL PARTITION
RAISED FLOOR PANEL - ELAVATOR FLOOR

CALCIUM SILICATE BOARDS

EXTRA DURABLE
100% ASBESTOS FREE
AMERICAN QUALITY

FLOOR - EAVES
FLOOR UNDERLAY
ROOF UNDERLAY



DURAFlex Jointing Compound
for the best solution, since 10.2014

DURAf^{te}x

The calcium silicate boards have been used nearly one hundred years in developed countries with full applications in interior and exterior designs. With the prominent characteristics such as water-resistance, fire-proofing, sound-insulation, thermal insulation... calcium silicate boards increasingly shows its advantages highly suitable for warmness, humidity and heavy rainfall in Vietnam and has gradually become popular construction materials.

Recognizing the potential development of calcium silicate boards and desiring to bring the most optimal solutions to customers, Vinh Tuong has launched to the market one product called EXTRA-DURABLE (calcium silicate boards) with the trademark named DURAf^{te}x.

- DURAf^{te}x is applied to the exposed ceiling, concealed ceiling, external partition, underlay, underlay flooring, floor panels and elevator flooring...
- DURAf^{te}x is manufactured with the most popular thicknesses being 3.5 mm, 4 mm, 4.5 mm, 6 mm, 8 mm, 9 mm, 10 mm, 12 mm and other levels of thickness and sizes, which can be custom-made
- DURAf^{te}x is 100% asbestos free, made from the environmentally friendly natural materials ASSURE HEALTH and SAFETY FOR USERS.



With the commitment of 50 years warranty, being 100% asbestos free, and having perfect smoother surface than other products, Duraflex is expected to always bring satisfaction to users.

Contents

DURAf^{te}x	2
Specifications	4
Technical information	5
Application to exposed ceiling	6
Application to concealed ceiling	8
Application to drywalls and external partitions	10
Application to floor underlay	12
Application to residence flooring and raised flooring	14
Warnings and Warranty	16
Transportation and Storage	18
About Vinh Tuong	19



DURAf^{te}x is complied with:



ISO 14001



ISO 9001



Complies with ASTM C1186-08 (American Standard)

MOISTURE RESISTANCE



BEING HIGH SCREW WITHDRAWAL STRENGTH



SAG RESISTANCE



BRIGHT, FLAT, SMOOTH SURFACE



TERMITE AND PEST RESISTANCE



FIRE RESISTANCE



The Singapore Green Labeling Scheme Secretariat hereby grant

Hiep Phu Corporation

Lot G22B, No. 1 Street, Long Hau Industrial Park, Can Giuoc District, Long An Province, Vietnam

the right to use the Singapore Green Label for

DURAllex - Fiber Cement Board
041-074-2093

"Made From Recycled Material"











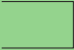

Validity: 20 June 2014 to 19 June 2015



JOSE RAYMOND
Chief Executive Officer
Singapore Environment Council



SPECIFICATIONS

DURAFlex with high durability is suitable for wet areas with different applications, depending on thickness as follows:

THICKNESS	TYPE OF EDGE	SIZE	WEIGHT OF BOARD (Kg) ^(*)	WEIGHT PER M2 (Kg/m ²)	APPLICATIONS
3.5 mm		605 x 1210	3.9	5.3	Exposed ceiling
3.5 mm		1220 x 2440	15.9	5.3	Exposed ceiling
4 mm		605 x 1210	4.3	6	Exposed ceiling
4.5 mm		1220 x 2440	22	7.4	Exposed ceiling
6 mm		1220 x 2440	27	9	Exposed ceiling, concealed ceiling
8 mm		1220 x 2440	34	11.4	Concealed ceiling, drywalls, eaves, floor underlays,
9 mm		1220 x 2440	40	13.4	Concealed ceiling, drywalls, internal partition, eaves, floor underlays,
10 mm		1220 x 2440	45	15.1	Drywalls, internal partition, floor underlays,
12 mm		1220 x 2440	55	18.4	Drywalls, internal partitions, floor underlays, roof underlays,
15 mm		1220 x 2440	70	23	Flooring – house ground
18 mm		1220 x 2440	80	27.5	Elevated flooring - raised floor panels
20 mm		1220 x 2440	82	27.6	Elevated flooring - lift floor panels
Others thickness/size	Custom-made	Custom-made	Custom-made	Custom-made	

- Squared- edge 
- Recessed - edge 

(*): Date of test: 14/04/2015

TECHNICAL INFORMATION

CHARACTERISTICS	VALUE	STANDARDS
Density	1.35 - 1.45 g/ cm ³	ASTM C1185
Fire resistance (1)	unflammable	BS 476 part 4
Surface spread of flame (2)	Spreading index of flame = 0 Spreading index of smoke < 5	ASTM C1186 - 08
Thermal insulation (3)	120 minutes at 600°C or 150 minutes at 550°C	-
Moisture content	8 - 10 %	ASTM C1185
Moisture movement	0.06 %	ASTM C1185
Water absorption	<35 %	ASTM C1185
Water-proof Capacity (4)	Satisfaction	ASTM C1186 - 08
Vertical Flexural Strength (5)	15 - 19 Mpa	ASTM C1186 - 08
Horizontal Flexural Strength (6)	11 - 13 Mpa	ASTM C1186 - 08
Average Flexural Strength	13 - 16 Mpa	ASTM C1186 - 08
Vertical/Horizontal Flexural Strength Rate (7)	65 - 70 %	-
Impacts (Impact strength) (*)	10 - 14J	JIS A 1408 : 2001
Delamination	Non-delamination	-
Screwing Resistance (Level)	Being unbreakable when screw shooting	-

The characteristics are tested and certificated:

(1): by TUV in Singapore

(2): by TUV in America

(3): by Vina Control

(4), (5), (6), (7): (by) Quatest 3

(*): Test on 3.5mm board

■ Kg/m³, Mpa (N/mm²), J: being units in the International System of Units (SI) in line with each of the characteristics above.

■ ASTM C1186-08: American Society for Testing and Materials BS

■ 476: British Standard 476 Fire Tests On Building Materials JIS A

■ JIS A 1408:2001: Japanese Industrial Standards

EXPOSED CEILING

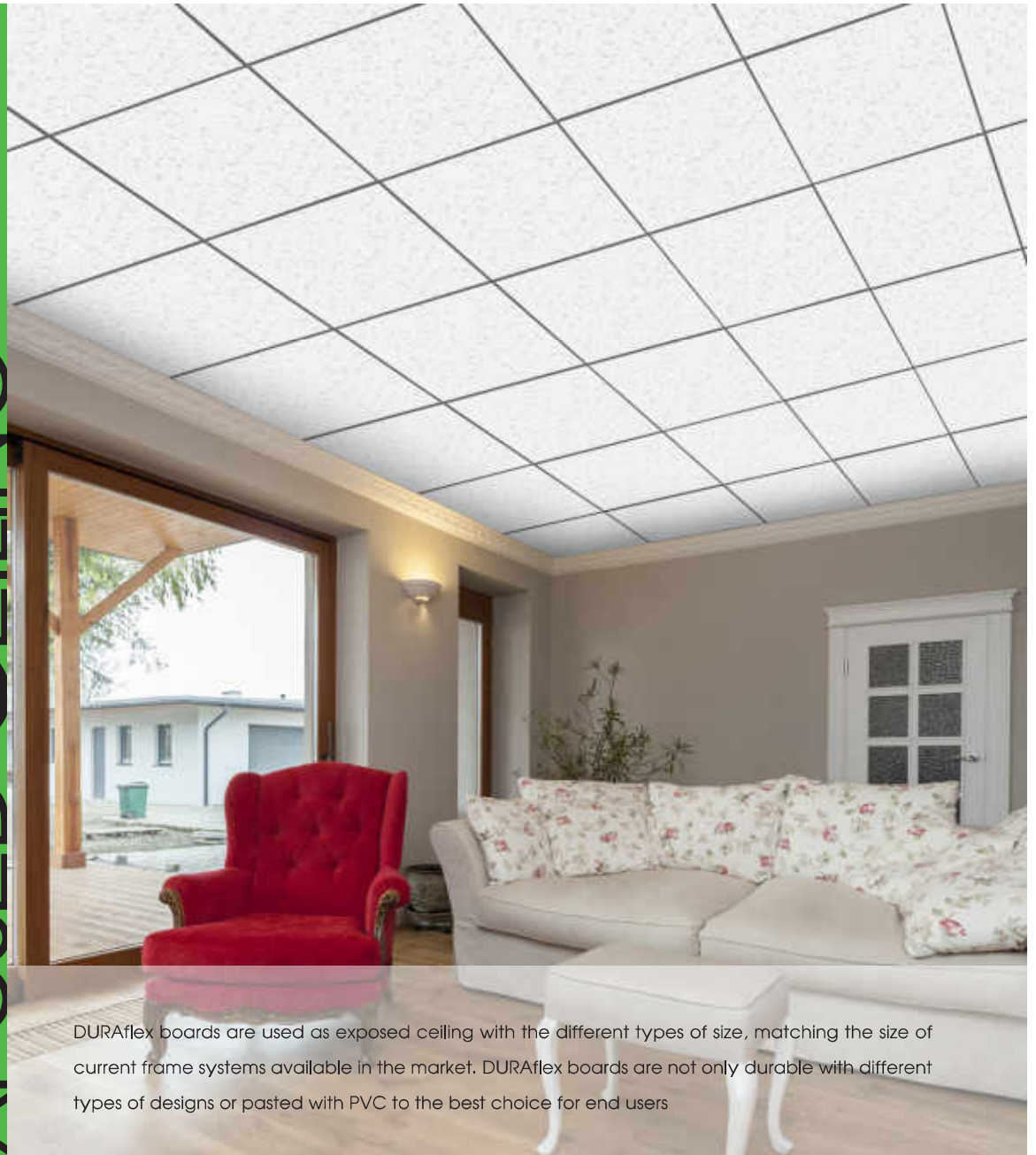

DURAFlex boards are used as exposed ceiling with the different types of size, matching the size of current frame systems available in the market. DURAFlex boards are not only durable with different types of designs or pasted with PVC to the best choice for end users

■ After completing, the installation of exposed ceiling frame system continues to lay the tiles boards already cut in the way selected for the frame system. The specifications often used for the exposed ceiling are as follows:

Frame system	610 x 610 mm	610 x 1220 mm	600 x 600 mm	600 x 1200 mm
Size of tiles	605 x 605 mm	605 x 1210 mm	595 x 595 mm	595 x 1190 mm

■ Maximum load that the ceiling system bears when hanging the decorative lights:

Thickness	Maximum load(Kg/m ²)	Accessories
3,5mm	4,5	Bolt anchor
4mm	5	Bolt anchor
4,5mm	7	Bolt anchor



Bolt anchor

■ For the best performance of ceiling system, we recommend Duraflex to be used with Vinh Tuong ceiling frames.



VINH TUONG SMARTLINE



VINH TUONG TOPLINE Plus



VINH TUONG FINELINE Plus

EXPOSED CEILING PATTERNS ON DURAFlex BOARDS (*)



VĨNH TƯỜNG **deco plus**[®]
HELLO SPRING



VĨNH TƯỜNG **deco plus**[®]
CARA



VĨNH TƯỜNG **deco plus**[®]
DANDELION



VĨNH TƯỜNG **deco plus**[®]
BAMBOO



VĨNH TƯỜNG **deco plus**[®]
HOÀNG SA K



VĨNH TƯỜNG **deco plus**[®]
HARMONY



VĨNH TƯỜNG **deco plus**[®]
OLYMPIC



VĨNH TƯỜNG **deco plus**[®]
FIREWORK



VĨNH TƯỜNG **deco plus**[®]
SOCOLA



VĨNH TƯỜNG **deco plus**[®]
CLIMAX

(*) Patterns were designed and copyrighted by Vinh Tuong

CONCEALED CEILING

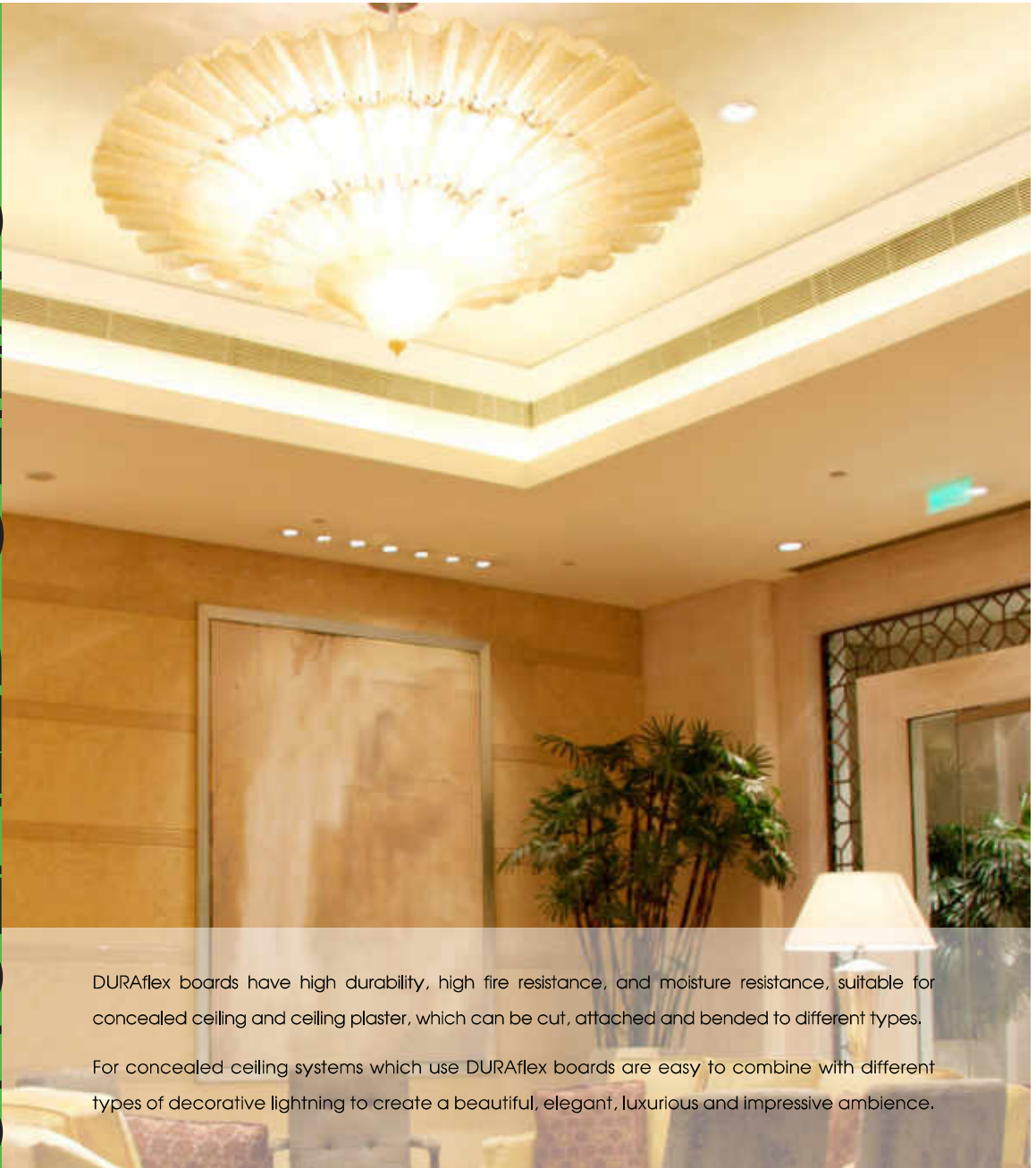

DURAFlex boards have high durability, high fire resistance, and moisture resistance, suitable for concealed ceiling and ceiling plaster, which can be cut, attached and bended to different types.

For concealed ceiling systems which use DURAFlex boards are easy to combine with different types of decorative lightning to create a beautiful, elegant, luxurious and impressive ambience.

- Maximum load ceiling system can stand when hanged with the decorative lights:

Thickness	Maximum load (Kg/m ²)	Accessories
6mm/8mm	10	Bolt anchor



Bolt anchor

- For the best performance of ceiling system, we recommend Duraflex to be used with Vinh Tuong ceiling frames:



VINH TUONG OMEGA



VINH TUONG SERRA



VINH TUONG TRIFLEX



VINH TUONG ALPHA



VINH TUONG BASI



VINH TUONG TIKI



VINH TUONG EKO

When installing DURAflex boards for concealed ceiling boards must be installed staggered to avoid cracking. Attach the DURAflex boards to the concealed frame system according to the following guidelines:

A. DRILLING SCREWS AND FIXING BOARDS

■ Screwing:

The spacing from corners to screws is 50 mm, and the spacing from edges to screws is more than 12 mm.

The gap between screws:

- + Ceiling: 150mm at the edge & 240mm inside. Using M3.5 x 25mm screws for 6-8mm boards.
- + Drywall: 200mm at the edge & 300mm inside. Using M3.5 x 25mm screws for 8-10mm boards & M3.5 x 40mm screws for 12mm.
- + Floor: 200mm at the edge & 300mm inside. Using M3.5 x 40mm self-drilled screws.

■ Fixing the board:

Before joining the joint: the gap between ends of boards is:

- + Ceiling & drywall: 2-3mm
- + Floor: 3-5mm

Examples: drywall

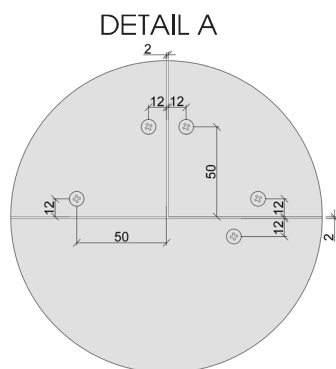
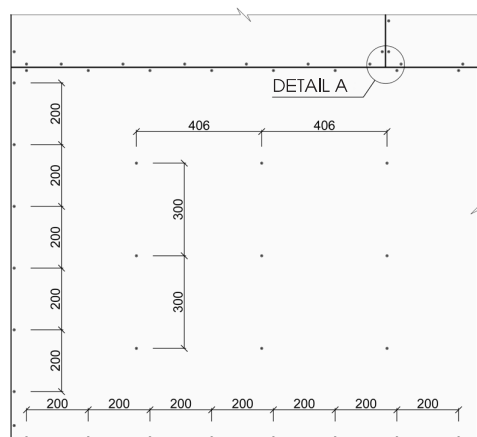

B. HOW TO JOIN THE GAP BETWEEN THE FLAT JOINTS

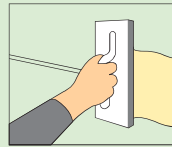

■ Step 1:

- + Fill the thin gap between the boards with DURAflex Joint Compound.
- + Plaster the screw heads with joint-processing powder.

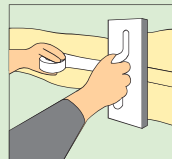

■ Step 2:

- + After 6h, fill another layer of DURAflex Joint Compound of around 75mm then paste a paper tape (already soaked with water) on the layer of powder just filled in. Using the trowel to press and strongly push the recently-pasted (with proper strength) to press the layer of powder underneath to spread to both edges of the paper tape.
- + Plaster the screw heads for the second time.

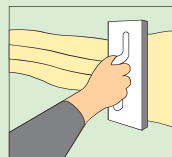
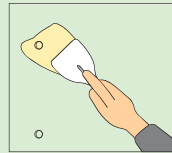

■ Step 3:

- Cover the surface of the recently plastered paper tape with a layer of powder, to make this layer of powder to fully cover the whole surface of the paper tape.

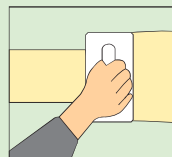

■ Step 4:

- + After 20 mins, plaster the next layer of DURAflex Joint Compound of around 125mm thickness on paper tape.
- + After drying, plaster the last layer of around 175mm thickness.
- + Using scrapper to smoothly scrap the surface.

■ Step 5:

- Finishing & painting.

DRYWALL & EXTERNAL PARTITION



DURAflex drywall boards are used to create durable, sound-insulated, moisture-resistant, water-proof, fire-proof and can replace brick/cement wall systems, which requires long construction-time or to add to the lighter structure, to save the cost and reduce the construction-time of high-rise building projects.

Use Vinh Tuong V-WALL or Vinh Tuong V-SHAFT and other functional such as sound-insulated, thermal insulation and fire-proofing walls with additional reinforcements depending on the functions. With the good waterproof capacity and suitability for harsh climate conditions, DURAflex boards are usable for the external partitions or in the heavily humid areas such as kitchen, bathroom, sauna, and cold – storage warehouses...

For the best performance of drywall system, we recommend DURAflex to be used with Vinh Tuong drywall frames:



VINH TUONG V-SOUND



VINH TUONG V-SHAFT



VINH TUONG V-WALL



VINH TUONG E-WALL

PERSPECTIVE OF DRYWALL SYSTEM FOR WET AREAS

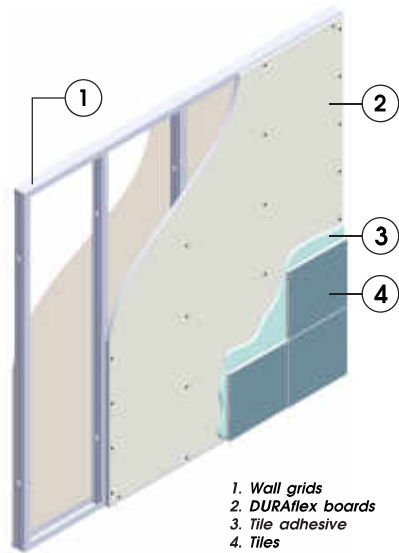

1. Wall grids
2. DURAFlex boards
3. Tile adhesive
4. Tiles

Being able to install anchors into walls used to hang heavy things with the load as below:



1. Bolt anchor
2. DURAFlex boards
3. Reinforced boards

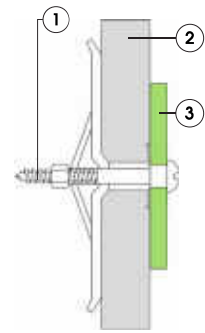

Thickness (mm)	Maximum load (Kg/m ²)	Accessories
8/10/12	80	Bolt anchor

- Install DURAFlex boards into the wall frame system according to guidelines in Item A, Page 9
- How to join the joint for the drywall system:

a. The flat joint

1. Flatly plastering the joint
2. DURAFlex boards with the tapered edge
3. Screws
4. Punched paper strips

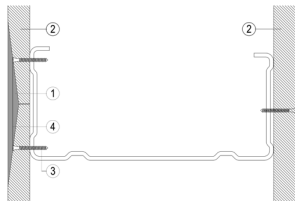

To join the flat joint according to guidelines in Item B, Page 9.

b. Creating engraved cuts

1. Splints
2. DURAFlex boards
3. Anti-rust screws

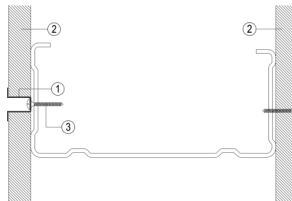

c. Embossed border

1. Being corniced by wood, plastic or metal
2. DURAFlex boards
3. Screw

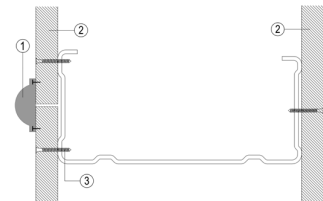

- Then completing the wall surface by painting, sticking to the decorative paper, installing wood or tiles... (For humid areas such as bathrooms...the coating tiles are recommended.)

When installing with DURAFlex boards at the door, and the window, the cut width should not be larger than 100 mm.

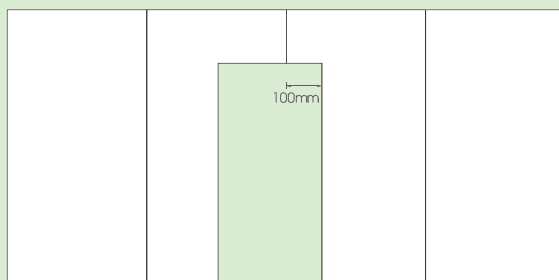

CAUTIONS:

- 1 When installing the concealed ceiling and wall at the same time, the ceiling must be installed first and the wall, later.
- 2 For the specialized sound-proof wall, the wall is installed first then the ceiling.
- 3 For the wall width of more than 10 meters, a dilatation gap is created to avoid cracking.

FLOOR UNDERLAY

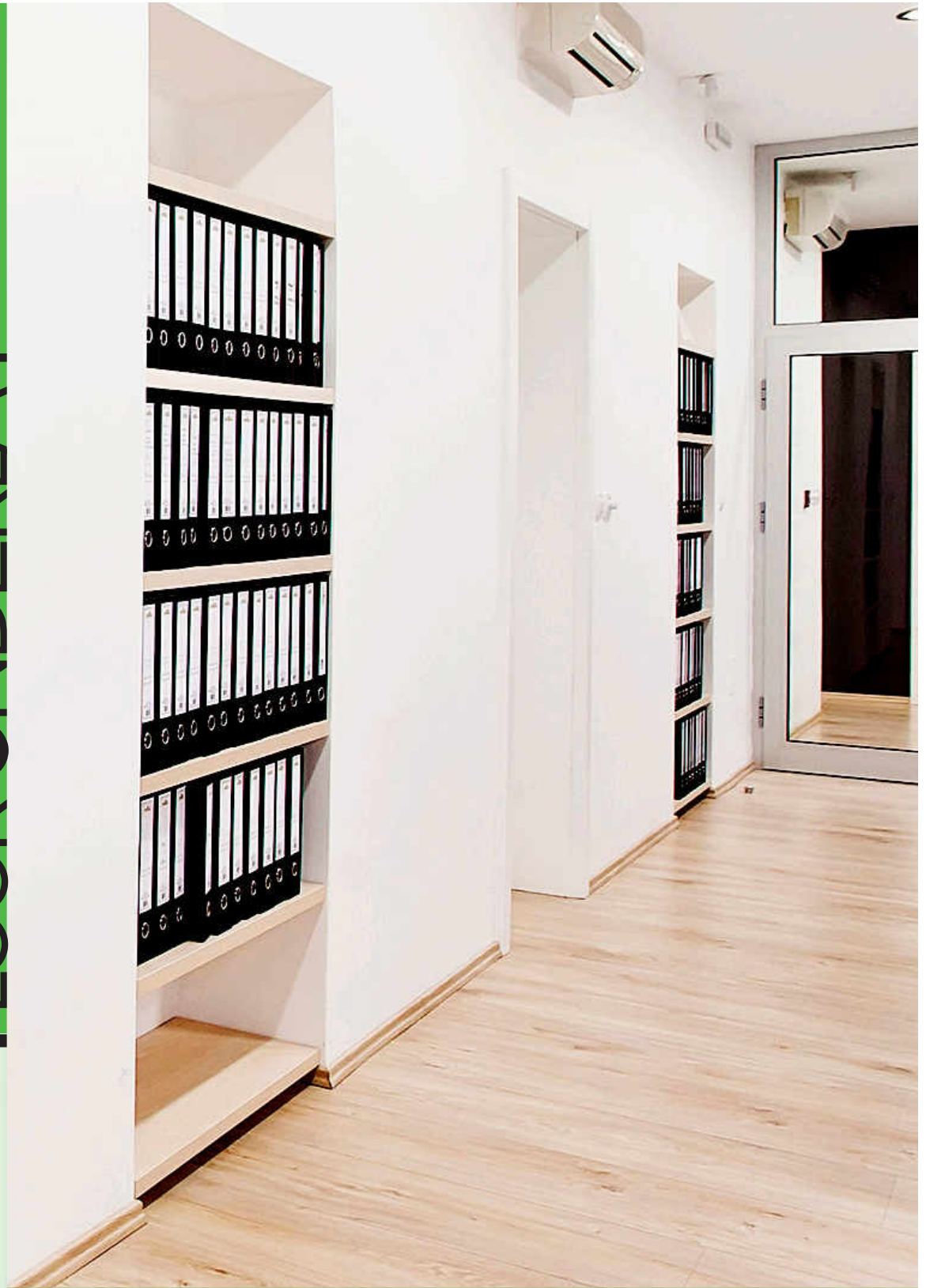

DURAFlex boards are used to replace cement lining with long construction-time or expensive the plywood lining to reduce construction-time and save the cost.

- Being used as the floor lining for wood flooring and tile flooring...for constructions such as hotels, restaurants, towers, trade centers, and residential houses.
- Besides, DURAFlex boards 8mm - 9mm can be used to underlay the eaves concrete roof structures.

THE STRUCTURE OF UNDERLAY SYSTEM:

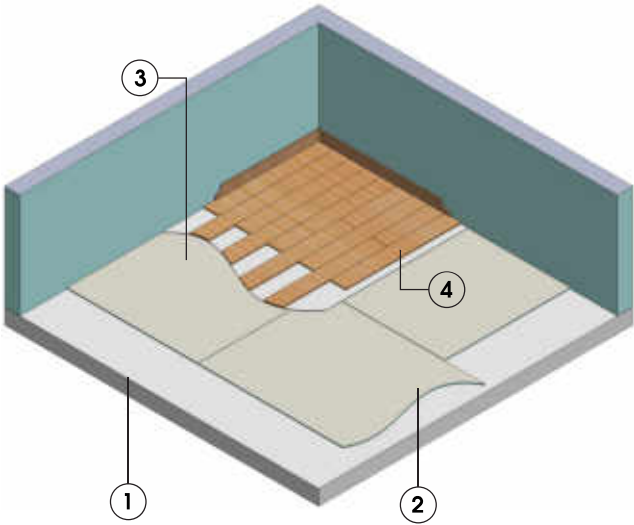

- 1. Crude floor
- 2. DURaflex boards
- 3. Underlying foam
- 4. Wood



FLOOR - RAISED FLOOR PANELS



DURAflex boards have types of thickness 15mm, 18mm with hard surface and high weight load capacity, are applied to the raised floor panel for works:

- Repairing, expanding works request low weight load capacity and no influence on the existing loading capacity of concrete flooring or the basement.
- Works that require quick installation time and saving-cost such as: office, trade center, buildings, workshops, house...
- Flooring for stairs or elevators.

Install DURAflex boards into the flooring grid according to Guidelines in Item A, Page 9.
 After finishing the installation; using rug, coating wood or tile... to complete the surface on your demands.

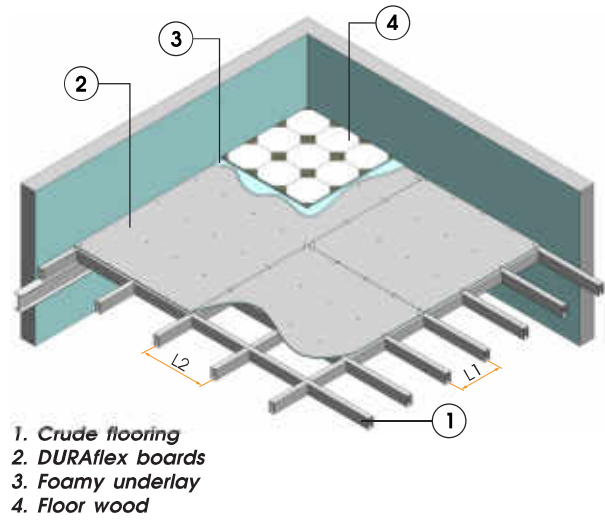

LOADING CAPACITY

Aperture (mm) (L1 X L2)	LOADING CAPACITY (kg/m ²)						
	DURAflex 12mm	DURAflex 15mm	Other Cement boards 15mm	Wood Cement boards 15mm	DURAflex 18mm	Other Cement boards 18mm	Wood Cement boards 18mm
300 x 300	2222	4169	2718		5022	3914	
300 x 400	1933	3300	2286		4133	3292	
400 x 400	1275	2413	1529		2913	2201	
300 x 600	1556	2867	1978		3422	2848	
400 x 600	1083	1818	1220		2183	1757	
600 x 600	772	1017	679		1217	978	
600 x 1200	436	719	494		900	712	
400 x 1200	563	1133			1275		
407 x 1220				530			760

WARRANTY

WARRANTY RESPONSIBILITY

Vinh Tuong commits to offer a 50-year warranty for the product durability since the manufacture date. The products are durable in any normal conditions of environment, and anti-deterioration, anti-worm.

The product warranty includes end-product quality. Vinh Tuong offers a warranty in compliance with ASTM C1186 standards and the internal standards of HPC factory. The end-products would not have any faults caused by manufacturing process or materials.

End-users are the beneficiary of the warranty policy of Vinh Tuong, and this policy is not applicable at the same time to the dealers in the product consumption cycle in the same case.



THE WARRANTY PROCESS OF VINH TUONG

- Vinh Tuong will examine, check, and conduct the warranty according to the regulations if the panels have some faults by manufacturing process or durability loss within the warranty limit. Vinh Tuong will overcome by repairing, replacing those products with a quantity equal to the confirmed broken quantity.
- The decision to compensate (if any) is a unilateral decision by Vinh Tuong, and there is no negotiation.

THE CONDITIONS OF USE

1 Before constructing, the panels must be preserved in dry and clean areas, use pallets according to instructions, avoid damages caused by rain and excessive humidity. In transportations, keep the panels from colliding, being scratched, or broken in any parts before and after constructing.

2 Construct the panels according to the valid recommendations and regulations from Vinh Tuong at the time of working. Be compliant to the principles in the Technical Handbook which is published widely at the Delivery Centers and on Vinh Tuong's website www.vinhthuong.com.

3 All types of panels must be constructed at the areas having appropriate conditions of temperature and humidity. The temperature in the working environment must not be over 50°C, and the relative humidity (RH) not over 99% when constructing the products. Working in the environmental conditions where there is no water, no direct or indirect water-absorbents from the around sources, not even condensation or leak from the pipes, or steam that may touch the panels or ceiling and partition structures.

4 Do not use the panels as materials for other purposes. Use the panels with their thickness as recommended by Vinh Tuong and use frames and accessories as high quality as Vinh Tuong's standards.

5 Do not use the space above the ceiling, ceiling panels as places for pipes supplying gas to the building. Do not use the ceiling as place to hang directly a lamp system or mechanical and electrical devices.

CONDITIONS THAT THE WARRANTY IS INAPPLICABLE

1 Vinh Tuong is not responsible to offer a warranty for the damages caused by transportation, or unsuitable preservation.

2 No warranty for the products constructed differently from the Technical Handbook announced by Vinh Tuong.

3 No warranty for the damages caused by water condensation, steam impacting directly on the materials of ceilings and partitions. The causes may include, but not limited to, building constructions, water leak, condensation, less efficient operation of mechanical refrigeration units, and other causes impacting directly and causing witness the surface of the panels.

4 No warranty in case of force majeure such as fires, explosions, tornados, storms, flood, earthquakes, severe weather or other natural calamities; (i) mold, coating paint peeling off, dirty spots on the coating paint; (ii) the development of molds, bacteria, or any kinds of organisms on the surface of the product (though not yet appearing); (iii) ceiling collapse caused by other reasons.

5 No warranty for damages caused by inappropriate maintenance, using for wrong purposes, chemical vapor, external factors, vibration, and normal wear.

LIMITS OF THE WARRANTY

1 The warranty is valid during 50 years as from the manufacture date. The manufacture date is printed on the back of the products.

2 Vinh Tuong will not be responsible for any charges occurring during the handling process: charges of dismantling, constructing, replacing, and disposing; charges of accessories; charges of workers, transportation; fees of finance and fees of other responsibilities different from the ones mentioned above, or occurring by any other causes.

3 Vinh Tuong just only offers the warranty for its products, and not any staff, delivery centers, dealers could add other terms to this policy of warranty.

HOW TO GET THE WARRANTY?

It is necessary to send a document to announce the faults within 30 days since the day faults are detected to the Department of Complaint Resolution:

The head office of VINH TUONG Industrial Corporation - M Floor, IPC Building, 1489 Nguyen Van Linh Street, Phu My Hung Ward, District 7, HCMC.

Hanoi Branch Office: 14th Floor, LILAMA 10 Tower, To Huu St., Nam Tu Liem Dist., Hanoi City

Hotline: 18001218

STORAGE

To avoid the breakage and damage upon impact, ensure DURAflex boards are kept in the best conditions. Neatly stack the boards on the pallet.

Wrap 4 corners with aluminum bars carton with the plastic wrapping and fix with plastic belts

Put pallets vertically one above another with the maximum height of 3.2m



Locate 4 corners (carton) by 4 aluminum angle grids, wrap the pile with a plastic film and belt by traps.



The total height of pallet is not over 3.2m



Stack on the pallet neatly



A part of the pile is not covered by plastic film

LOADING/ UNLOADING

To ensure that DURAflex boards are loaded/unloaded by right methods, Vinh Tuong's loading/unloading guidelines must be kept.

Lift the DURAflex board from the middle of the board sides. Always bring the boards vertically while moving during the process of handling.

A part of the pile is not covered by plastic film.

The board is sagged down when being held horizontally.



Lift DURAflex board from the middle of the board sides.



When moving, DURAflex should always be lifted edge-up, with the board width oriented vertically.



The board is sagged down when moving with the board width oriented horizontally.

TRANSPORTATION

It is encouraged to use Forklift to bring up and down the boards from transportation means or move pallets from one place to another.

When transporting by truck, containers:

- Reinforce pallets on trucks/containers to avoid sliding and colliding together during transportation time.
- If transported by truck, there should be cover to protect the boards from rain and wind.





ABOUT VINH TUONG



■ Founded in 1991, Vinh Tuong Industrial Corporation (Vinh Tuong) is the first company in Vietnam in manufacturing and supplying products such as suspended ceiling frames, wall frames and decorative ceilings to replace the imported products. Nowadays, Vinh Tuong is the biggest trademark in Vietnam, provides the total ceiling and drywall solutions, with the growth rate of 500% in the past 5 years. The whole system of management and production achieves International Standards ISO 9001:2008, and was certificated by SGS (Switzerland), ASTM (USA), BS (UK), (with 10-years warranty. Vinh Tuong is honored to be awarded the National Gold Quality Award in 2012 as well as in the Top 100 Vietnam Gold Star for many years and the top 10 companies, producing construction materials and top 250 biggest private companies in Vietnam (VNR 500).

■ Hiep Phu Factory (HPC) is the first factory to manufacture calcium silicate boards with no asbestos in Vietnam, invested by Vinh Tuong, on a big scale, using the advanced world technology with brand-name DURAflex, and is located at Long Hau Industrial Zone, Long An Province. The factory with the total area of 20,000 m², and the production capacity of 8 million m²/year. HPC is invested with more than 200 billion VND with the modern international manufacturing technology process, with ISO 9001:2008. Through the automated and specialized production lines, the factory ensures products reaching the international standards (ASTM – American), which is certificated by TUV Rheinland – a German certification organization.

■ In HPC, DURAflex boards are manufactured with modern Autoclave technology, which keeps steaming the product for a long time. The high temperature and high pressure helps to stabilize and improve the long-term durability and satisfies are expected to satisfy demands in the market.

■ HPC with the advantage is produced locally and combined with the wide distribution network of Vinh Tuong, always initiative the supply, willing satisfy the best and fastest orders to works and needs of residence in regions in the country.



EXTRA DURABLE

100% ASBESTOS FREE

END-USER SUPPORTING TOOLS:

1 Ceiling & Drywall Application

Download at:
www.vinhtuong.com/tinhvattu



2 NHIP SONG THI CONG Magazine



3 Ceiling & Drywall Installing Instruction



4 DURAflex Jointing Compound Instruction



VINH TUONG' S SYSTEM OFFICE:

SOUTHERN AREA

Office: M Floor, IPC Tower
1489 Nguyen Van Linh St., Dist. 7, HCMC
Tel: (08) 377 61 888 - 377 63 888
Fax: (08) 377 60 824

NORTHERN AREA

Office: 14th Floor, LILAMA 10 Tower,
To Huu St., Nam Tu Liem Dist., Hanoi City
Tel:(04) 3785 6688
Fax: (04) 3556 6685

VTJ SINGAPORE

No.4 Chin Bee Road Singapore 619819
Tel: (65) 6899 8138
Fax: (65) 6899 8136

DISTRIBUTION NETWORK IN SOUTHERN AREA

Store 1: 333 To Hien Thanh St., Ward 13, Dist. 10, HCMC
Tel: (08) 3865 6853 / Fax: (08) 3865 4275
Central Branch: No.9 St., Hoa Cam IZ, Cam Le Dist., Da Nang City
ĐT: 0901 857 940
Eastern Branch: No. 2 Truong Son Highway, Ward Hiep Binh Phuoc, Thu Duc Dist., HCMC
Tel: (08) 3727 3013 / Fax: (08) 3727 2524

DISTRIBUTION NETWORK IN NOTHERN AREA

Sub-area 1: Vinh Bao Hamlet, Vinh Khuc Commune, Van Giang Dist., Hung Yen Province
Tel: (0321) 3788 888 / Fax: (0321) 3788 886
Sub-area 2: Lot 48 Quang Minh IP, Me Linh Dist, Hanoi City
Tel: (04) 3 586 0062 / Fax: (04) 3 813 4925
Sub-area 3: National Sport Complex, Le Duc Tho St.,
Me Tri Commune, Tu Liem Dist., Hanoi City
Tel: (04) 7305 1618 / Fax: (04) 7305 1619

TECHNICAL CONSULTANT – TOLL FREE: **1800 1218**

For more information, please visit our website:
www.vinhtuong.com or www.tranhhadep.com

 **VINH TUONG**[®]
TOTAL CEILING & DRYWALL SOLUTION

FAST500

WR
500
COMPANY

1000
TOP BRAND



FOR DISTRIBUTIONS